

Celotex Crown-Bond is a brand new product for use in flat roof systems. Representing the next phase of Celotex innovation, Crown-Bond is a rigid polyisocyanurate (PIR) board which delivers cutting edge thinness, increased dimensional stability and added robustness in a bonded single ply flat roofing system.

Celotex Crown-Bond flat roof PIR insulation has the following product features:

- Innovative composite facers on both sides
- Low lambda 0.022W/mK offering high thermal performance
- Suitable for bonded single ply membranes
- Excellent compressive strength, giving it increased dimensional stability and added robustness
- An extensive package of online support, tools and aftercare

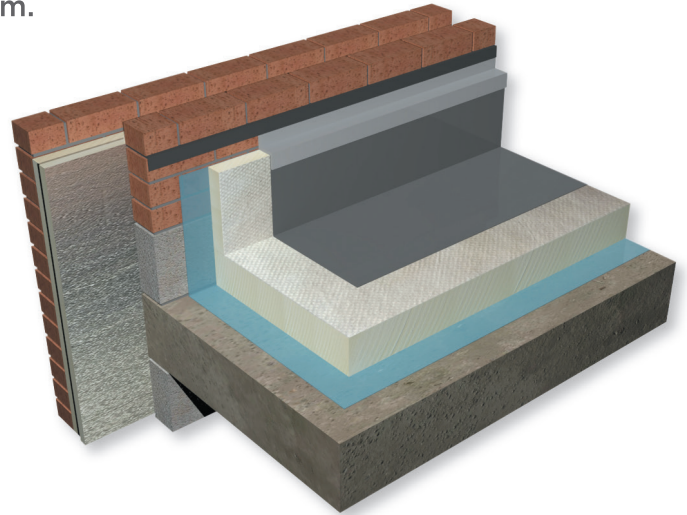

## Applications

- ✓ Suitable to be used on fully sealed metal, timber and concrete decks
- ✓ Compatible with bonded single ply membranes
- ✓ Secured to the deck with fully bonded systems or thermally broken or mechanical fasteners

## Specification clause

The insulation shall be Celotex Crown-Bond \_\_\_\_mm thick comprising of polyisocyanurate rigid foam insulation core with a thermal conductivity of 0.022W/m<sup>2</sup>K and a composite facer on both sides. Crown-Bond is CFC/HCFC free with zero ODP and low GWP and CE marking compliance to BS EN 13165. Crown-Bond is manufactured in accordance with quality management system ISO 9001 and environmental management system ISO 14001. All products must be installed in accordance with instructions issued by Celotex.

## Technical data

Thickness (mm)	R-value (m <sup>2</sup> K/W)	Weight (kg/m <sup>2</sup> )
50	2.25	2.77
100	4.50	4.69
120	5.45	5.46
140	6.35	6.23

## Physical properties

Compressive strength	≥150kpa
Dimensional stability	DS(70,90)3 - DS(-20-)1
Thermal conductivity	0.022W/mK
Board size	600 x 1200mm

## Typical U-values

U-values will vary depending on application. To calculate a specific U-value, please visit our online calculator at [celotex.co.uk](http://celotex.co.uk)

## Installation guidelines

For Celotex Crown-Bond installation details please refer to our online 'applications' pages.

## Further information

If you wish to contact Celotex, please do so through the 'contact us' page on our website.

For information regarding storage, installation and handling of Celotex products, or for health & safety advice, please refer to our online 'literature' pages.

Celotex has a policy of continuous product development and reserves the right to alter product designs or specifications without prior notice.

Saint-Gobain Construction Products UK Limited trading as Celotex. Registered Office: Saint-Gobain House, Binley Business Park, Coventry CV3 2TT. Registered in England and Wales No 734396

