



Celotex PL4000

Plasterboard Thermal Laminate Insulation Board

Celotex
Insulation Specialists

Introduction

Celotex PL4000 is a high performance thermal insulation board where the PIR insulation is bonded to tapered edge plasterboard.

PL4000 is manufactured from rigid polyisocyanurate (PIR) using a blowing agent that has zero ozone depletion potential (zero ODP) and low global warming potential (GWP).

With Celotex PL4000 you are specifying an insulation board that:

- Can be easily used to upgrade to current building regulation standards in pitched roof, flat roof and wall applications
- Ideal option for internal solid wall insulation
- Is suitable for both direct bonding ('dot and dab') and mechanically fixed installation techniques
- Featuring an inbuilt vapour control layer
- 15mm option provides ideal solution for window and door reveals
- Is certified under BBA certificate number 12/4926
- Ofgem approved
- Offers the installer maximum flexibility and installation speed due to the tapered edge plasterboard
- Offers the user the ability to install both the insulation and plasterboard in one operation, thus reducing installation times
- Future proofs the energy performance of new and existing buildings

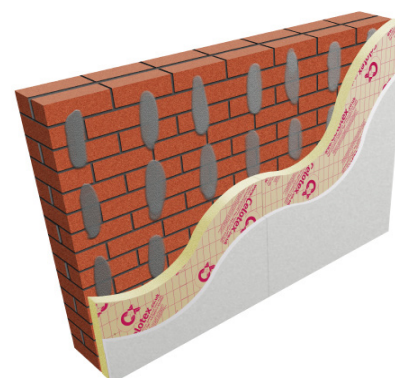

Celotex PL4000 in a internal solid wall application

Applications

Celotex PL4000 can be specified for use in a variety of applications including:

- Solid masonry walls
- The "underneath" layer of insulation in between and under rafter and joist applications
- Timber frame lining applications

Specification Clause

The insulation shall be Celotex PL4000 _____mm thick comprising a polyisocyanurate rigid foam insulation core with a thermal conductivity of 0.022 W/mK with aluminium foil/kraft paper facings on both sides bonded to a layer of tapered edge plasterboard. Celotex PL4000 is CFC/HCFC free with zero ODP and low GWP and CE marking compliant to BS EN 13950. Celotex PL4000 is manufactured in accordance with BS EN 13950 quality management system ISO 9001 and environmental management system ISO 14001. All products must be installed in accordance with instructions issued by Celotex.

Sustainable Insulation

Celotex PIR insulation has been independently assessed by BRE Global and has been accredited with an A+ rating when compared to the BRE Green Guide.

The results also show that Celotex offers a lower environmental impact than other typical PIR manufacturers.

For further information about Celotex' sustainable insulation solutions, visit the sustainability pages of the website at celotex.co.uk



cont...



Celotex PL4000

Plasterboard Thermal Laminate Insulation Board

Celotex
Insulation Specialists

Celotex PL4000 Technical Data

Product Code	Thickness (mm)	R-value (m ² K/W)	Weight (kg/m ²)
PL4015	15 + 9.5	0.70	6.62
PL4025	25 + 12.5	1.20	9.06
PL4040	40 + 12.5	1.85	9.52
PL4045	45 + 12.5	2.10	9.67
PL4050	50 + 12.5	2.30	9.86
PL4055	55 + 12.5	2.55	10.01
PL4060	60 + 12.5	2.75	10.15
PL4065	65 + 12.5	3.00	10.30

Physical Properties (*insulation only)

	Method	PL4000
Compressive strength*	BS EN 826	≥120kPa
Dimensional stability*	BS EN 1604	DS(TH)8
Thermal conductivity *	BS EN 12667	0.022 W/mK
Fire resistance	BS EN 13501-1	Euroclass B-s1,d0

Typical U-values

U-values will vary depending on application. To calculate a specific U-value, please visit our online U-value calculator at celotex.co.uk

Installation Guidelines

Installation of Celotex PL4000 will depend on application type. For full details of the installation of Celotex PL4000, please refer to the 'applications' pages of the website at celotex.co.uk and select the application of interest.

Further Information

If you wish to contact Celotex, please visit celotex.co.uk and click on the 'contact us' page.

For information regarding [storage, installation and handling](#) of Celotex products, or for Health & Safety advice, please refer to the 'literature' pages of the website at celotex.co.uk.

Celotex has a policy of continuous product development and reserves the right to alter product designs or specifications without prior notice.

Celotex Limited
Lady Lane Industrial Estate,
Hadleigh, Ipswich
Suffolk IP7 6BA

T: 01473 820850
W: celotex.co.uk